

Roller Shutter GPO Locations
28.6.22

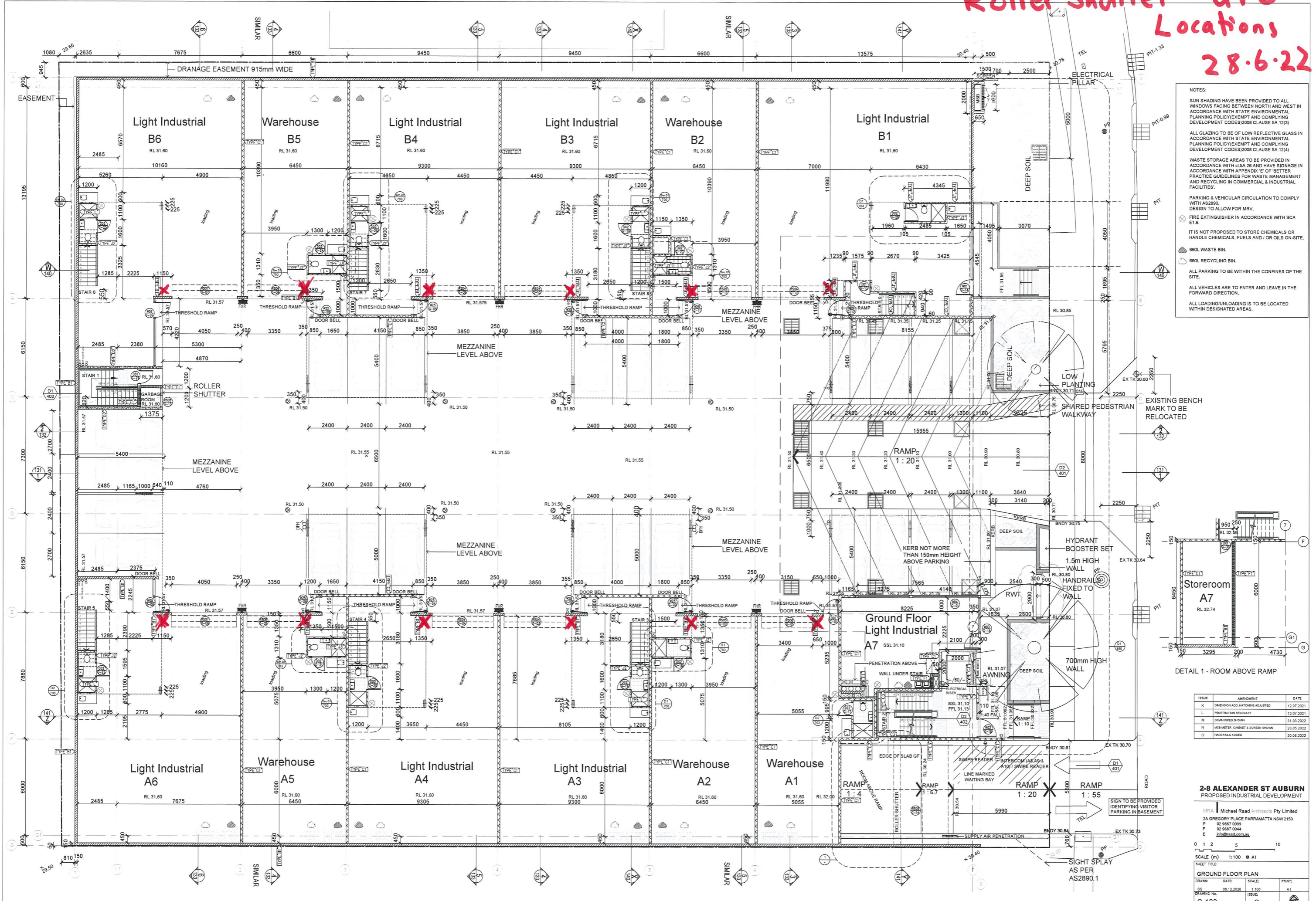

- NOTES:
- SUN SHADING HAVE BEEN PROVIDED TO ALL WINDOWS FACING BETWEEN NORTH AND WEST IN ACCORDANCE WITH STATE ENVIRONMENTAL PLANNING POLICY (EXEMPT AND COMPLYING DEVELOPMENT CODES) 2008 CLAUSE 5A.12(3)
 - ALL GLAZING TO BE OF LOW REFLECTIVE GLASS IN ACCORDANCE WITH STATE ENVIRONMENTAL PLANNING POLICY (EXEMPT AND COMPLYING DEVELOPMENT CODES) 2008 CLAUSE 5A.12(4)
 - WASTE STORAGE AREAS TO BE PROVIDED IN ACCORDANCE WITH 41 SA 28 AND HAVE SIGNAGE IN ACCORDANCE WITH APPENDIX 'E' OF 'BETTER PRACTICE GUIDELINES FOR WASTE MANAGEMENT AND RECYCLING IN COMMERCIAL & INDUSTRIAL FACILITIES'.
 - PARKING & VEHICULAR CIRCULATION TO COMPLY WITH AS2890. DESIGN TO ALLOW FOR MRV.
 - FIRE EXTINGUISHER IN ACCORDANCE WITH BCA E1.8.
 - IT IS NOT PROPOSED TO STORE CHEMICALS OR HANDLE CHEMICALS, FUELS AND / OR OILS ON-SITE.
 - 660L WASTE BIN.
 - 660L RECYCLING BIN.
 - ALL PARKING TO BE WITHIN THE CONFINES OF THE SITE.
 - ALL VEHICLES ARE TO ENTER AND LEAVE IN THE FORWARD DIRECTION.
 - ALL LOADING/UNLOADING IS TO BE LOCATED WITHIN DESIGNATED AREAS.

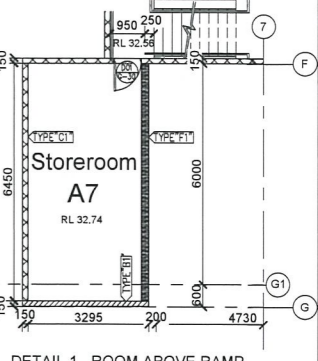

ISSUE	AMENDMENT	DATE
K	DIMENSION AND NOTING ADJUSTED	12.07.2021
L	PENETRATION RELOCATE	12.07.2021
M	DOOR PIPES SHOW	31.03.2022
N	MIS METER CABINET & SCREEN SHOW	23.05.2022
O	HANDRAILS ADDED	20.06.2022

2-8 ALEXANDER ST AUBURN
 PROPOSED INDUSTRIAL DEVELOPMENT

MRA | Michael Raad Architects Pty Limited
 2A GREGORY PLACE PARRAMATTA NSW 2150
 P 02 9687 0099
 F 02 9687 0044
 E info@mraad.com.au

0 1 2 5 10

SCALE (m) 1:100 @ A1

SHEET TITLE
GROUND FLOOR PLAN

DRAWN	DATE	SCALE	PRINT
SS	08.12.2020	1:100	A1

DRAWING No. C-122
 ISSUE: O

SIGN TO BE PROVIDED IDENTIFYING VISITOR PARKING IN BASEMENT

SIGHT PLAY AS PER AS2890.1